

The pressure of downstream is preset, cannot be changed and saves the procedures for adjusting/setting pressure

# Preset pressure regulator

**NEW!**

**Tamper proof**



**Compact and Light-weighted / 2.5in. 1oz.**

Length from 2.34 to 3 inches  
Weight from 0.85 to 1.2 oz.

Example) Suitable for supplying constant air pressure to vacuum generators

**Step 1** Tubing connection

**Push-in**

**Step 2** Compressed air

**On**

**Step 3**

No adjustments are needed

**Preset pressure**

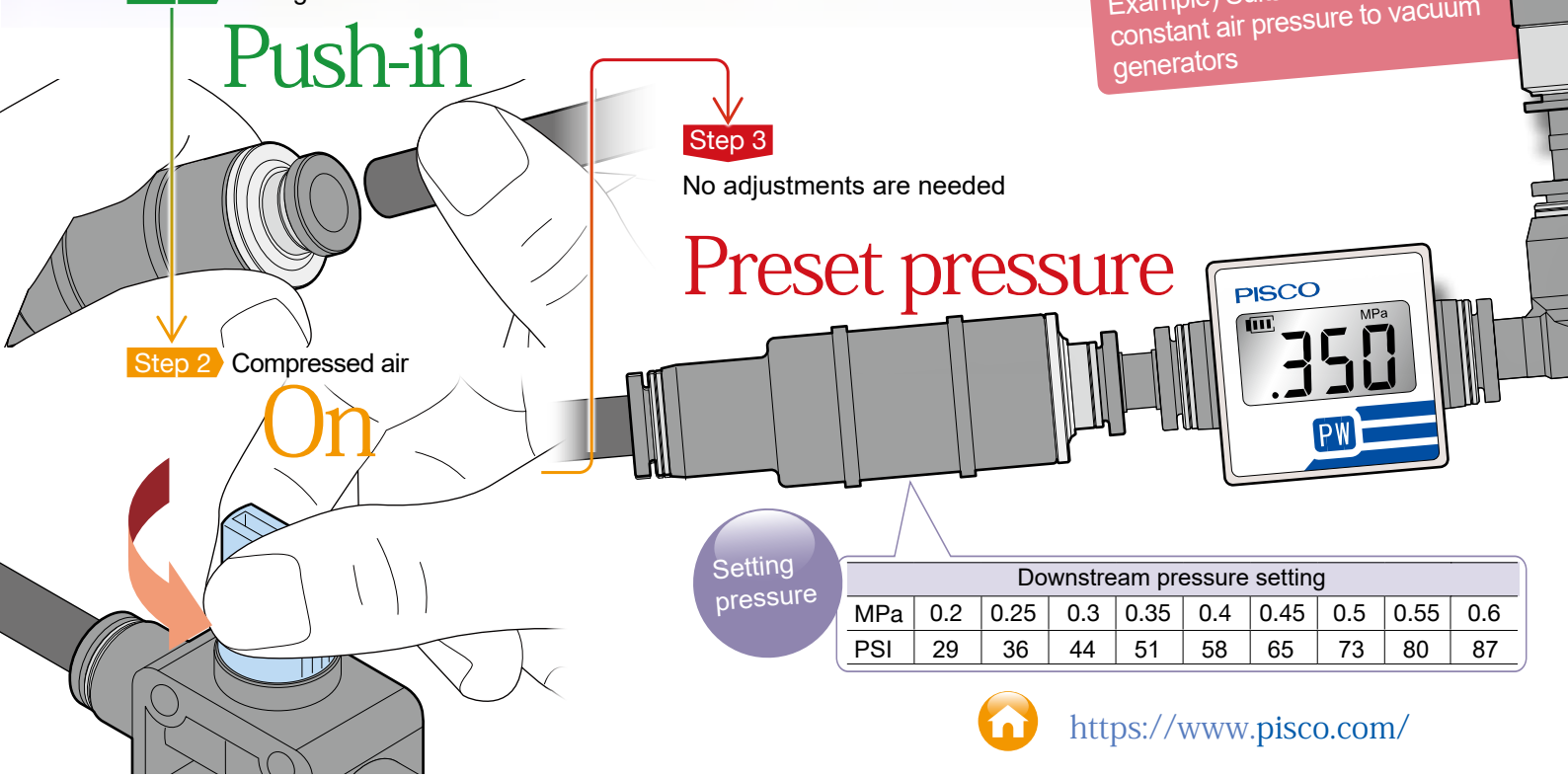

Setting pressure

		Downstream pressure setting									
MPa		0.2	0.25	0.3	0.35	0.4	0.45	0.5	0.55	0.6	
PSI		29	36	44	51	58	65	73	80	87	

Features

- Time saving for OEM products assemblies  
No need to adjust the secondary pressure due to pressure pre-set
- Tamper proof  
Preset - No adjusting knob nor screw
- In-line type regulator - Standard bracket is provided as option
- Compact body - 67% volume reduced (compared with RVUP type)

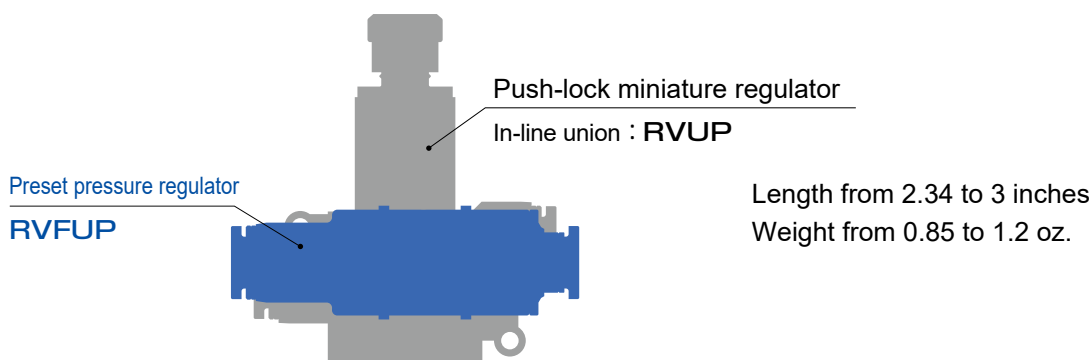

- Fluctuation of the outlet pressure is minimized even the inlet pressure changes

Pressure characteristic (comparison table) (ex.: in case of 0.2MPa as the outlet setting pressure)

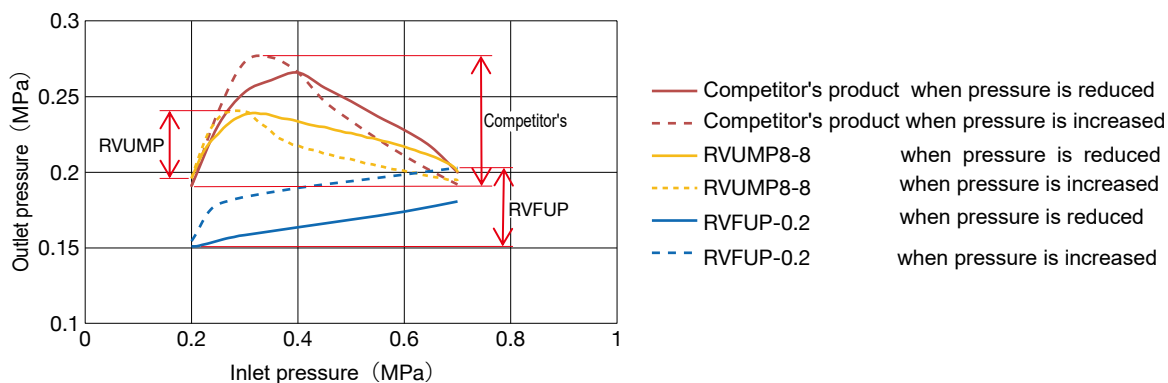

※1) Inlet pressure: 0.7MPa / Outlet pressure: 0.2MPa (setting) → Shift the pressure from 0.7MPa to 0.2MPa then back to 0.7MPa  
 ※2) Pressure characteristic is measured by the method leaking the outlet air through ø0.1mm bore orifice.

- Free reverse flow function

Can be used as a check regulator by installing it between solenoid valve and actuator.

※) In case the pressure of inlet side is lower than outlet side, air flows to inlet side. (No relief function though)

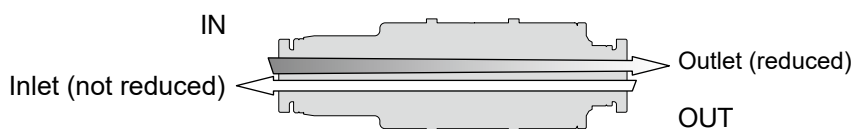

- Implementing the regulator on each actuator to save air consumption by appropriate compressed air being supplied.

## Model Designation (Example)



Preset pressure regulator

②. Outlet pressure pre-setting

Code	0.2	0.25	0.3	0.35	0.4	0.45	0.5	0.55	0.6
Outlet pressure MPa	0.2	0.25	0.3	0.35	0.4	0.45	0.5	0.55	0.6
psi	29	36	44	51	58	65	73	80	87

①. Port size (Tubing O.D.)

Code	Imperial size (in.)				Metric size (mm)			
	5/32-5/32	1/4-1/4	5/16-5/16	3/8-3/8	4-4	6-6	8-8	10-10
Tubing O.D.	ø5/32	ø1/4	ø5/16	ø3/8	ø4	ø6	ø8	ø10

### Bracket Model Designation



## Specification

Fluid medium	Air
Service pressure range	Preset pressure ~ 145psi (1.0MPa)
Service temperature range	32~140°F ( 0 ~ 60°C ) ( No freezing )
Pressure tolerance	±3.6psi (±0.025MPa) (When preset pressure+0.3MPa is supplied)

## Construction

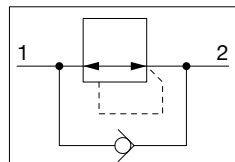

JIS symbol

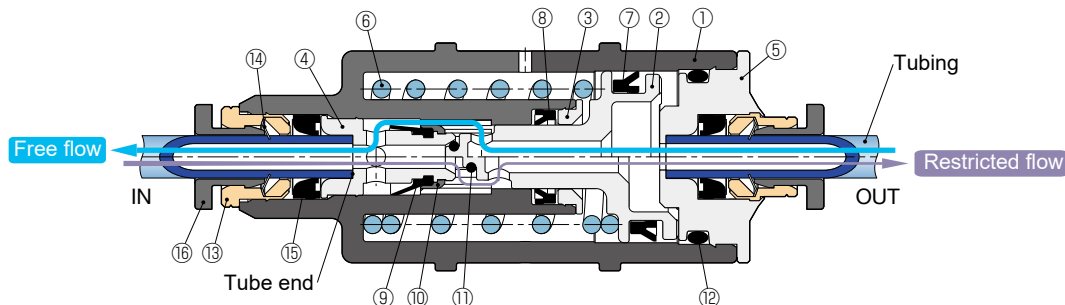

No.	Parts	Material
①	Resin body	PBT
②	Piston	POM
③	Seal retainer	Brass, electroless nickel-plating
④	Valve retainer	Aluminum
⑤	Fitting body	Aluminum
⑥	Spring	Stainless steel
⑦	Y shape seal	NBR
⑧	Rod seal	NBR

No.	Parts	Material
⑨	Y shape seal	HNBR
⑩	Check valve retainer	PBT
⑪	O-ring	HNBR
⑫	O-ring	NBR
⑬	Guide ring	Brass, electroless nickel-plating
⑭	Lock claws	Stainless steel
⑮	Elastic sleeve	NBR
⑯	Release ring	POM

## Precautions

### ⚠Warning

1. The product does not have a relief function. It can cause malfunction in the system if there is possibility the pressure of outlet side becomes higher than the inlet pressure.

### ⚠Caution

1. Do not use the products where the accuracies are required.
2. Rattling noise of chattering may occur depending on the pressure level and flow rate.

Dimensions

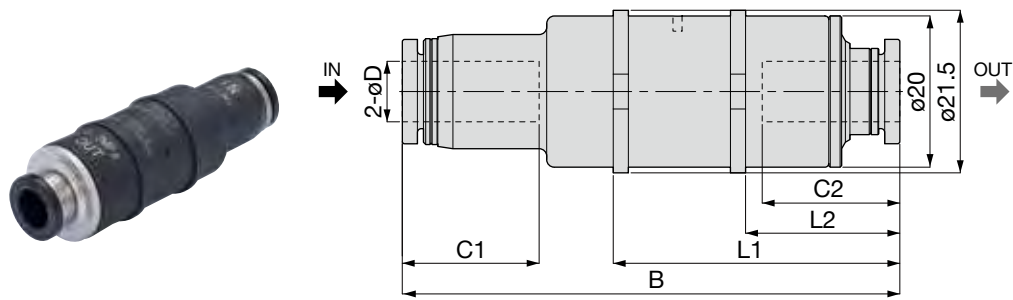

Unit : mm

Model	Tubing O.D. øD	B	L1	L2	Tube End C1	Tube End C2	Weight (g) (② (Outlet presetting pressure))								Price (\$)	CAD File name	
							0.2	0.25	0.3	0.35	0.4	0.45	0.5	0.55			0.6
RVFUP5/32-5/32-②	5/32in.	59.4	36.7	19.2	14.9	14.9	24	24	25	25	25	25	25	26	26	26.18	RVFUP5'32-5'32_
RVFUP1/4-1/4-②	1/4in.	62.4	37.7	20.2	17	17	26	26	26	26	27	27	27	28	28	28.00	RVFUP1'4-1'4_
RVFUP5/16-5/16-②	5/16in.	65.8	37.9	20.4	18.1	18.2	27	27	28	28	28	28	28	29	29	32.27	RVFUP5'16-5'16_
RVFUP3/8-3/8-②	3/8in.	76.1	46.1	28.6	20.2	20.7	33	33	33	33	34	34	34	34	34	38.18	RVFUP3'8-3'8_
RVFUP4-4-②	4	59.4	36.7	19.2	14.9	14.9	24	24	25	25	25	25	25	26	26	26.18	RVFUP4-4_
RVFUP6-6-②	6	62.4	37.7	20.2	17	17	26	26	27	27	27	27	27	28	28	28.00	RVFUP6-6_
RVFUP8-8-②	8	65.8	37.9	20.4	18.1	18.2	27	27	28	28	28	28	28	29	29	32.27	RVFUP8-8_
RVFUP10-10-②	10	76.1	46.1	28.6	20.2	20.7	32	32	33	33	33	34	34	34	34	38.18	RVFUP10-10_

Dimensions of Bracket

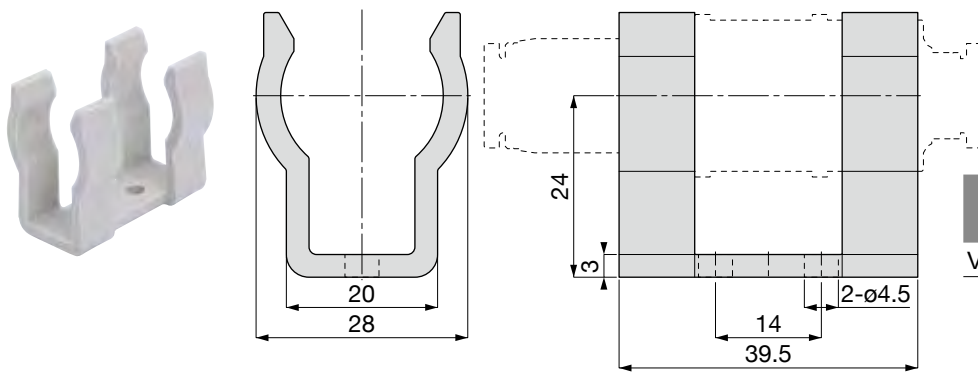

Unit : mm

Model	Weight (g)	Price (\$)	CAD File name
VFUH3	7.8	1.36	VFUH3

## Characteristics

0.2MPa preset models (Rated pressure: 0.5MPa)

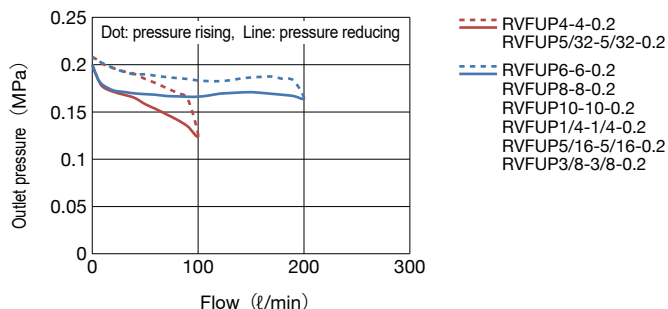

0.25MPa preset models (Rated pressure: 0.55MPa)

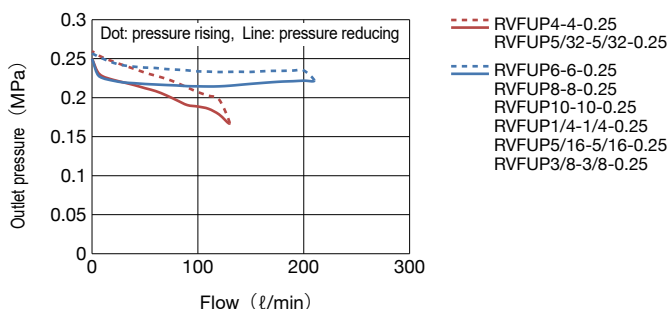

0.3MPa preset models (Rated pressure: 0.6MPa)

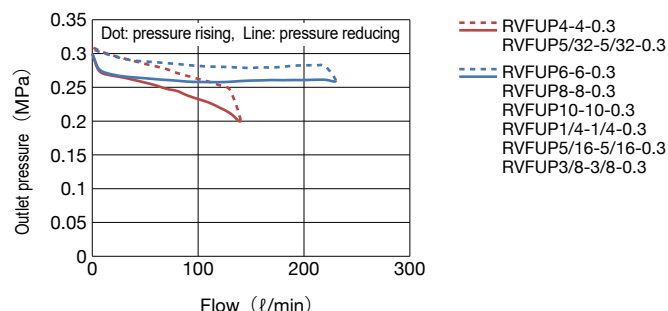

0.35MPa preset models (Rated pressure: 0.65MPa)

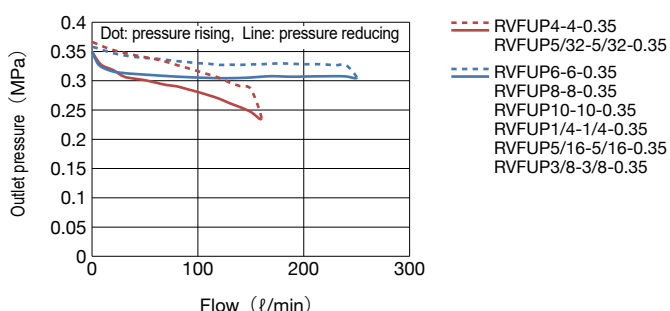

0.4MPa preset models (Rated pressure: 0.7MPa)

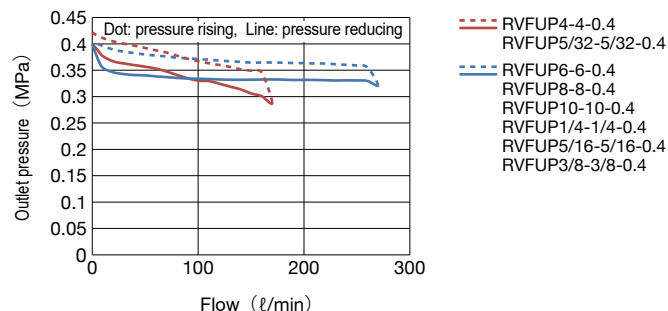

0.45MPa preset models (Rated pressure: 0.75MPa)

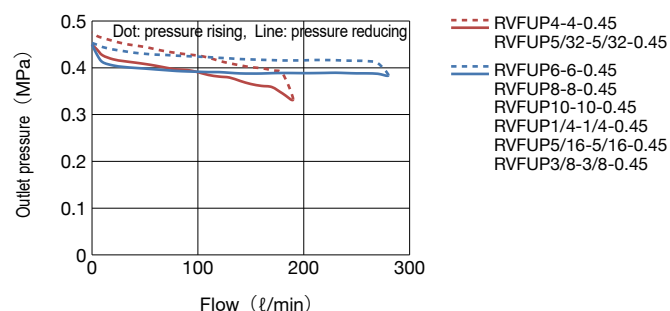

0.5MPa preset models (Rated pressure: 0.8MPa)

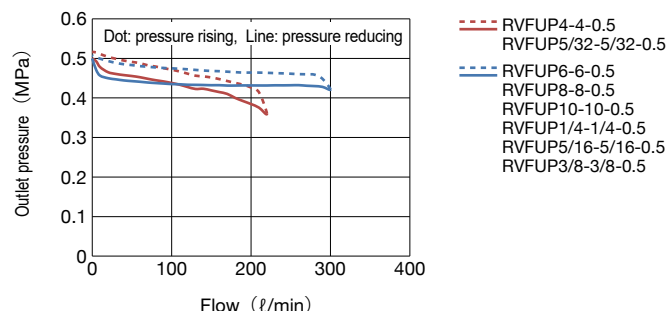

0.55MPa preset models (Rated pressure: 0.85MPa)

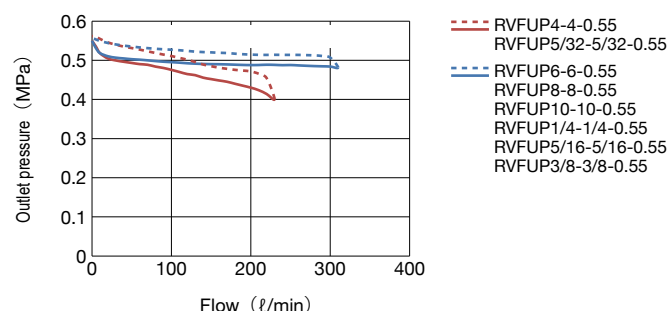

0.6MPa preset models (Rated pressure: 0.9MPa)

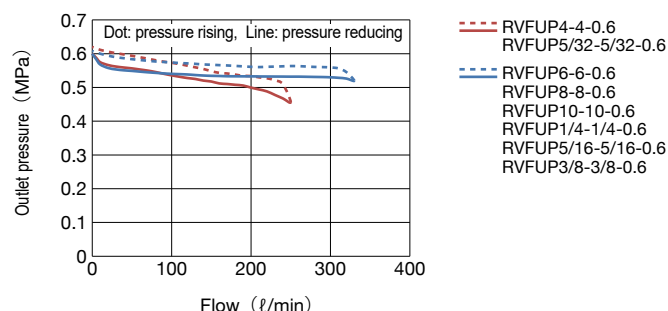

## Free flow characteristics

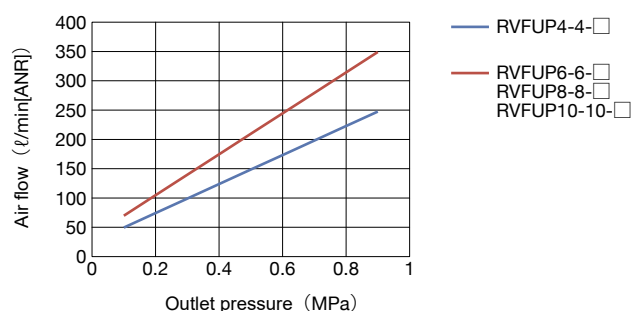

Pressure characteristics

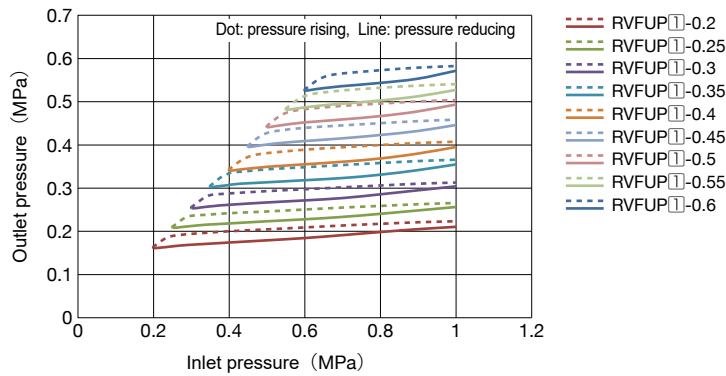

※ Inlet pressure changes : from 1.0MPa to Designated pressure, then back to 1.0MPa

Adjustable pressure regulator

Easy to adjust and set the pressure

Push-Lock type pressure regulator

**NEW!**



The structure newly designed enables about 1.3 times more flows

moreover

reduces pressure fluctuation range

Pressure characteristic (RVCP6-01)

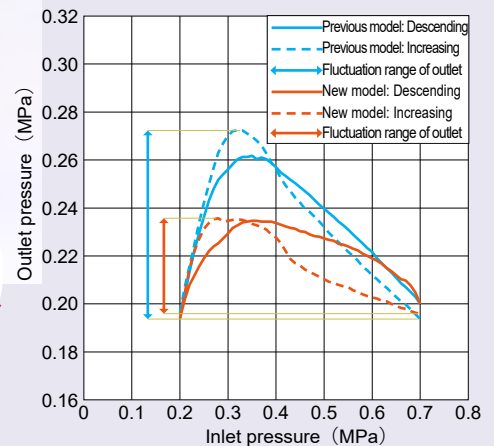

Note) Inlet pressure : 0.7MPa / Outlet pressure set at : 0.2MPa  
Then, change the inlet pressure from 0.7MPa to 0.2MPa then, back to 0.7MPa

Push down the adjusting knob to lock preventing the setting pressure from deviation due to machines' vibrations



The product has a self pressure relief function

Free reverse flow

can be used as a check regulator by installing it between solenoid valve and actuator

Certain models come with Pressure gauge